

FOR LEASE



Solis Sugar Hill

1172 Temple Drive, Sugar Hill, GA 30518

OVERVIEW

Sugar Hill Georgia is one of the most sought-after communities in North Atlanta. Home of the Sweet Life, Sugar Hill offers a high quality of living with nearby attractions, Lake Lanier and The Mall of Georgia. With an eclectic mix of restaurants, breweries and entertainment venues, Downtown Sugar Hill has become a popular destination. And, with the addition of hundreds of new luxury apartments and townhomes, also a popular place to live. Solis Sugar Hill adds more excitement to the area featuring street level retail, outdoor dining and new residences.



FOR MORE INFORMATION, PLEASE CONTACT: Todd Semrau | 404-371-4100 | tsemrau@oakrep.com

Information contained herein has been obtained from sources deemed reliable but we cannot guarantee its accuracy. No liability is assumed for errors or omissions.

FOR LEASE



Solis Sugar Hill

1172 Temple Drive, Sugar Hill, GA 30518



SOLIS SUGAR HILL HIGHLIGHTS

- » New Mixed Use Development in Downtown Sugar Hill
- » Delivery scheduled for late 2023
- » 4,400 SF Retail Space Available
- » Expansive Patio Space
- » 400 Parking Spaces
- » 375 SF Jewel Box
- » 290 Luxury Apartment Homes
- » Adjacent to the City Amphitheater, Splash Park and Performing Arts Center

Within 5 Miles



125,562

Population



41,069

Total Households



\$151,552

Average Household Income



46,000

Cars Per Day

FOR LEASE



Solis Sugar Hill

1172 Temple Drive, Sugar Hill, GA 30518

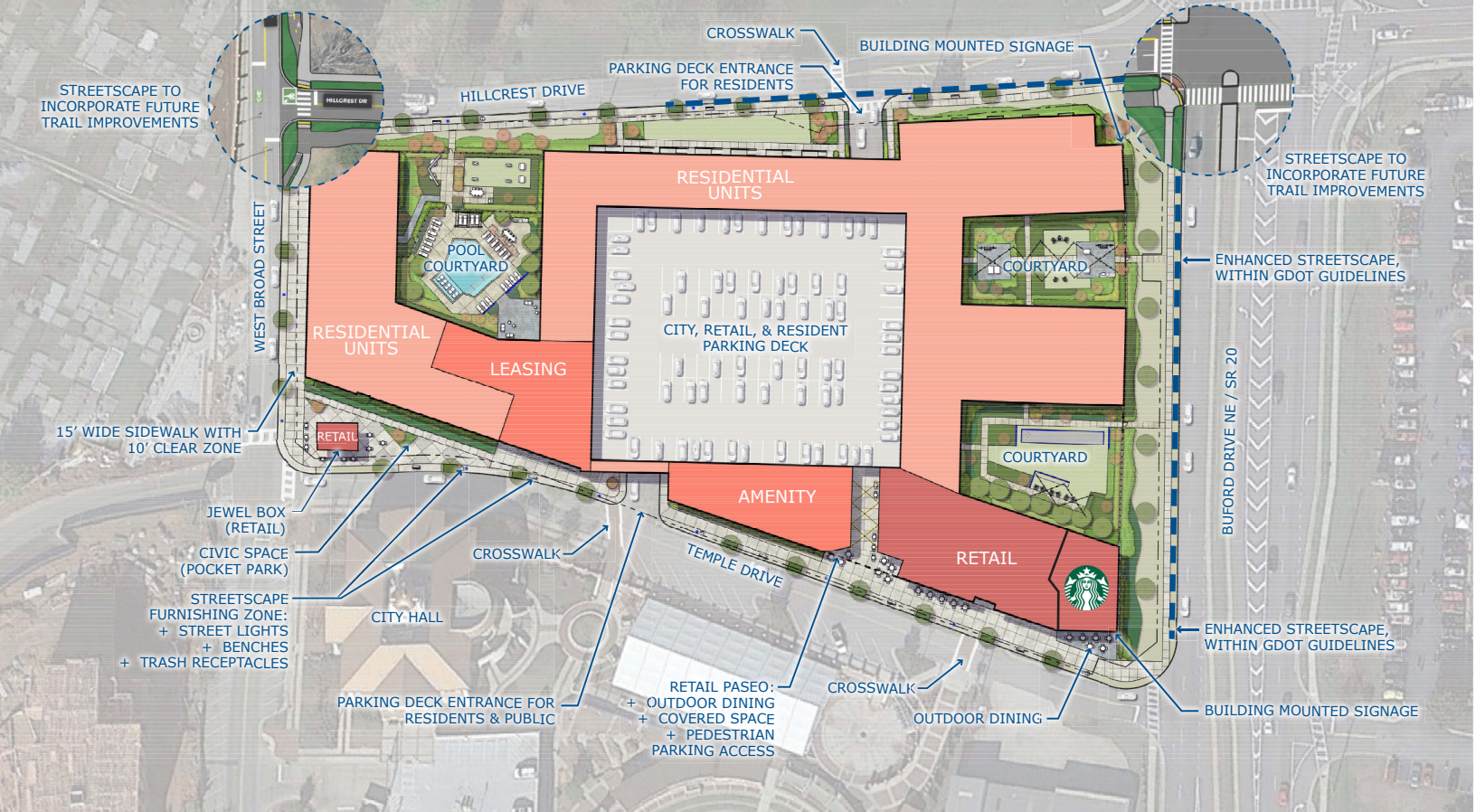

FOR MORE INFORMATION, PLEASE CONTACT: Todd Semrau | 404-371-4100 | tsemrau@oakrep.com

Information contained herein has been obtained from sources deemed reliable but we cannot guarantee its accuracy. No liability is assumed for errors or omissions.

FOR LEASE



Solis Sugar Hill

1172 Temple Drive, Sugar Hill, GA 30518

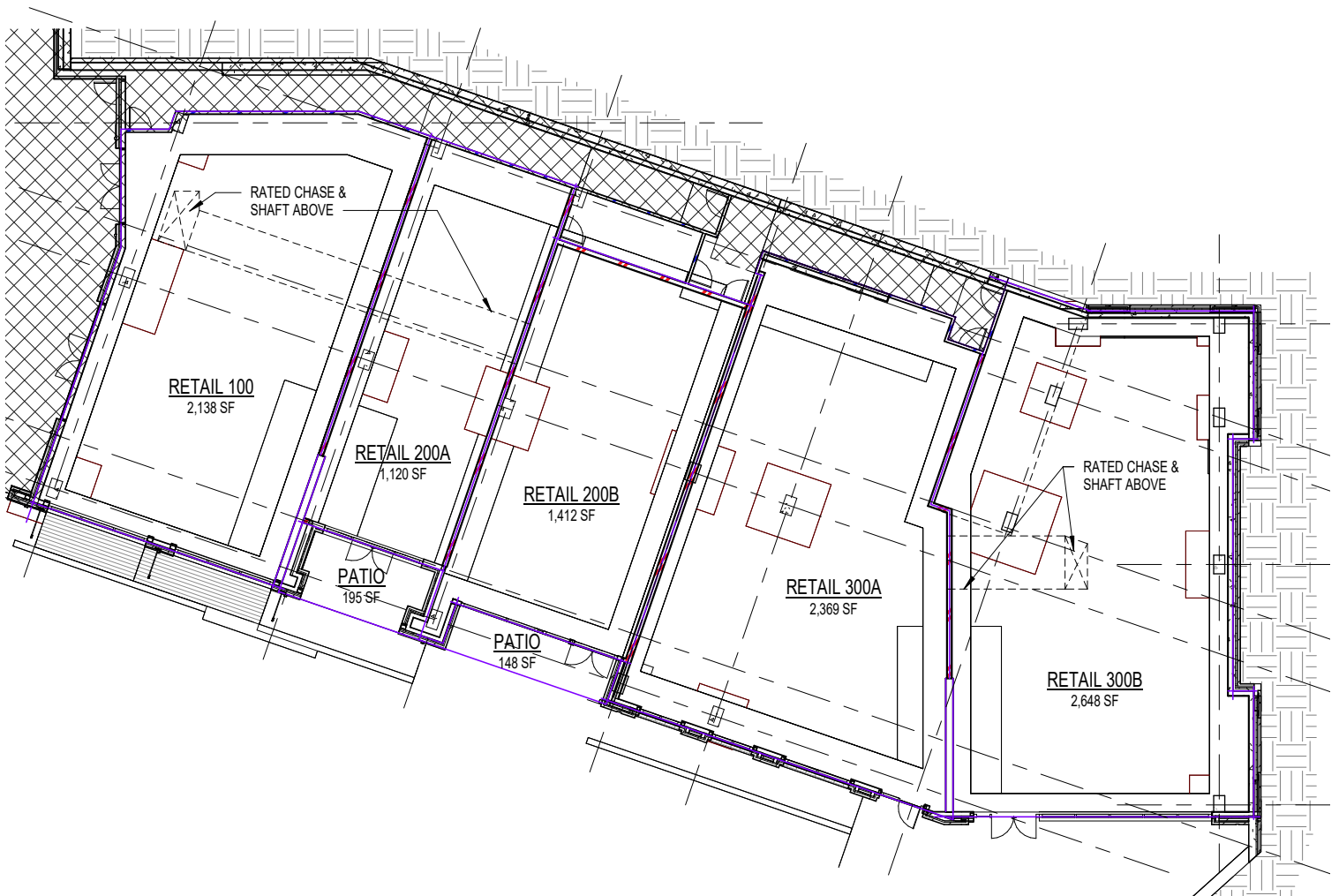

FOR MORE INFORMATION, PLEASE CONTACT: Todd Semrau | 404-371-4100 | tsemrau@oakrep.com

Information contained herein has been obtained from sources deemed reliable but we cannot guarantee its accuracy. No liability is assumed for errors or omissions.

FOR LEASE



Solis Sugar Hill

1172 Temple Drive, Sugar Hill, GA 30518

Downtown Sugar Hill



FOR MORE INFORMATION, PLEASE CONTACT: Todd Semrau | 404-371-4100 | tsemrau@oakrep.com

Information contained herein has been obtained from sources deemed reliable but we cannot guarantee its accuracy. No liability is assumed for errors or omissions.

FOR LEASE



Solis Sugar Hill

1172 Temple Drive, Sugar Hill, GA 30518

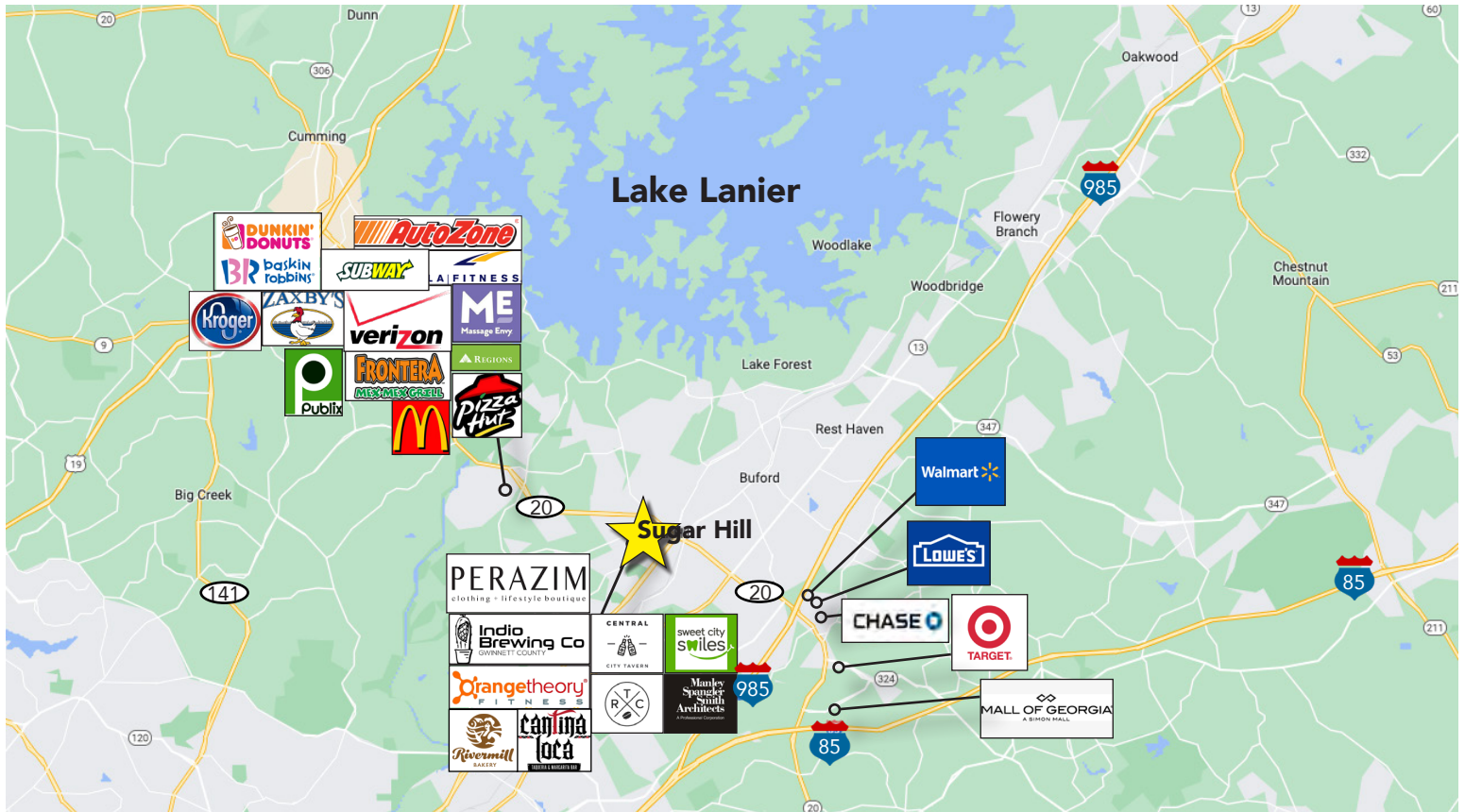

FOR MORE INFORMATION, PLEASE CONTACT: Todd Semrau | 404-371-4100 | tsemrau@oakrep.com

Information contained herein has been obtained from sources deemed reliable but we cannot guarantee its accuracy. No liability is assumed for errors or omissions.